

# D.T.MUX Sentinel™



## Accessories Sentinel Remote Control Unit

Remote control is an accessory of Sentinel unit who permit to display live status of the unit and to process to erase functionality and event marking or test following your installation.

Remote control can be fitted directly into cockpit DZUS installation following MIL-STD-MS25212.

Remote control is available with NVIS compatibility in option for compatibility with Night vision goggles in cockpit environment.

An area microphone with analog output is available in option to capture cockpit audio ambience.

An SD-Card is available in option, this one permit to record in mirroring the data acquired by the crash protected recorder.

### Main features

- MIL-STD-MS25212 installation (1.50in format)
- NVIS compatibility in option
- Aircraft backlighting compatibility
- Switch Guard cover for Erase function(s)
- Vivisun® buttons in option
- Area Microphone (Option) (Compliant ED-155A/ED-112B)
- SD-Card (Option) mirroring record form the recorder.



**MECHANICAL**

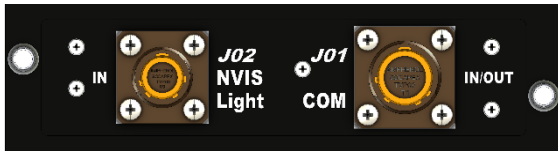

	Specification	Remark
<b>Size</b>	100.59 x 38.08 x 146 mm	D x W x H
<b>Weight</b>	≈ 320gr	Depend of PN#
<b>Connectors</b>	2x MIL-DTL-38999	Serie III
<b>Mounting</b>	DZUS Rail 1.50in format	Customizable

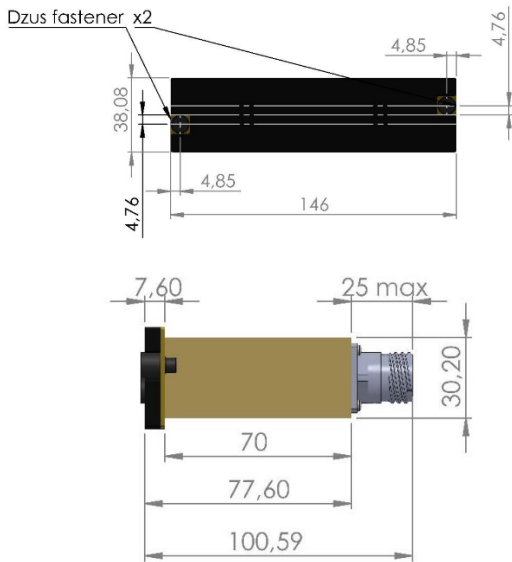

**FUNCTIONALITY**



	Specification
<b>STATUS</b>	Led Green/yellow/Red (NVIS option)
<b>ERASE</b>	<ul style="list-style-type: none"> <li>AUDIO ERASE (NVIS option)</li> <li>VIDEO ERASE (NVIS option)</li> <li>COMMON ERASE (NVIS option)</li> </ul> <i>All Erase buttons are supplied with Switch Guard cover</i>
<b>EVENT</b>	EVENT BUTTON (NVIS option)
<b>Or TEST</b>	TEST BUTTON for recorder
<b>NVIS INPUT</b>	NVIS Backlighting Aircraft power

**PART NUMBER COMPOSITION**

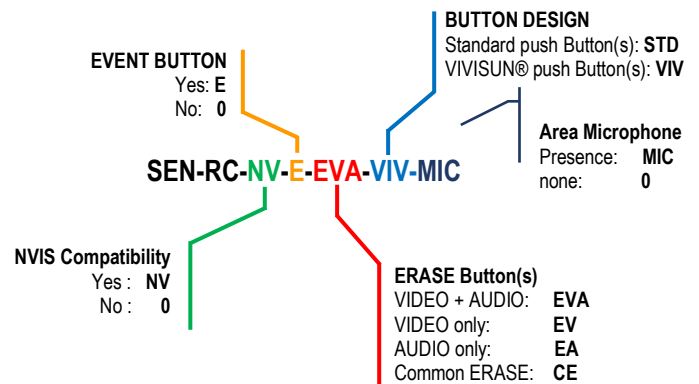

**ELECTRICAL**

<b>Input Voltage</b>	28Vdc (9 to 36Vdc)
<b>Power consumption</b>	≈ 6 Watts (Depend of model)
<b>Power Interruption</b>	≈ 60ms
<b>Standard</b>	MIL-STD-704F / DO-160

**ENVIRONMENTAL**

	Specification	Remark
<b>Temperature</b>	-40°C to 65°C	Operating
	-55°C to 90°C	Storage
<b>Cooling</b>	Passive	Convection
<b>Humidity</b>	95%	Non-Cond
<b>Vibration</b>	10Hz to 2KHz	
<b>Shocks</b>	20g 11ms	Operating
<b>Acceleration</b>	20g linear 3 axis	Operating
<b>Altitude</b>	+ 60,000 ft	Operating
<b>Decompression</b>	420Kpa/minute	Operating
<b>MTBF</b>	> 90,000 hours	Computed
<b>EMI</b>	DO-160	Rev G